

SITE LOCATION MAP - Berbera 9 Barnhill Road R829 Dalkey Dublin

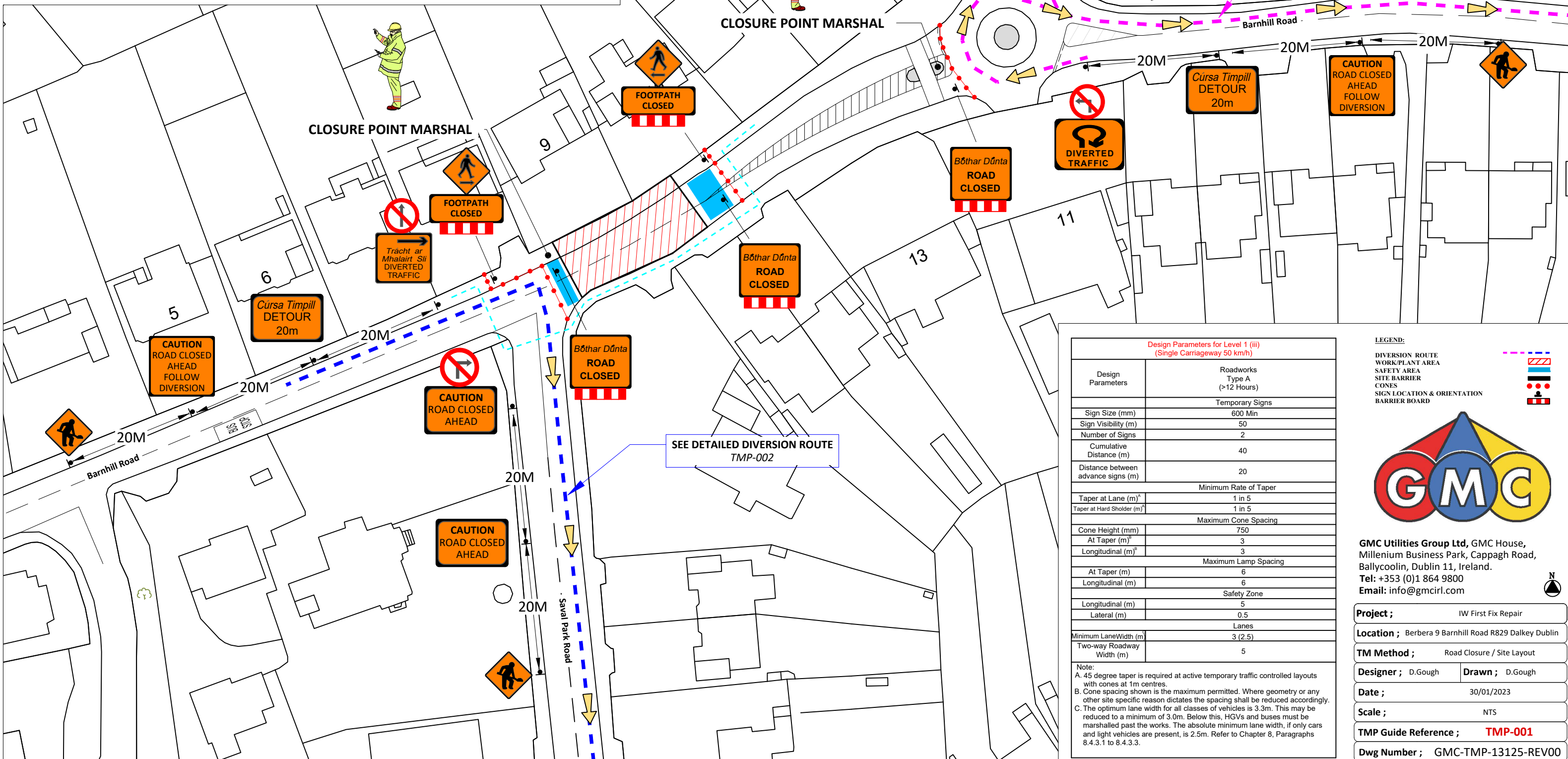
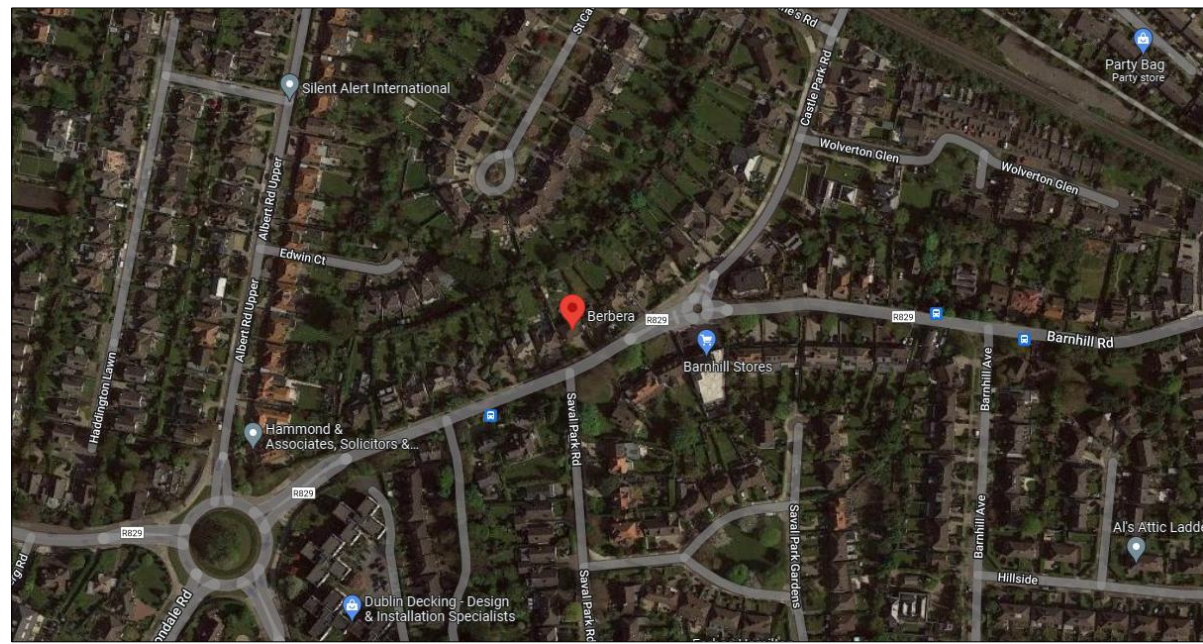

Design Parameters for Level 1 (iii)
(Single Carriageway 50 km/h)

| Design Parameters | Roadworks Type A (>12 Hours) |
|---|------------------------------|
| Sign Size (mm) | 600 Min |
| Sign Visibility (m) | 50 |
| Number of Signs | 2 |
| Cumulative Distance (m) | 40 |
| Distance between advance signs (m) | 20 |
| Minimum Rate of Taper | |
| Taper at Lane (m) ^a | 1 in 5 |
| Taper at Hard Shoulder (m) ^a | 1 in 5 |
| Maximum Cone Spacing | |
| Cone Height (mm) | 750 |
| At Taper (m) ^b | 3 |
| Longitudinal (m) ^b | 3 |
| Maximum Lamp Spacing | |
| At Taper (m) | 6 |
| Longitudinal (m) | 6 |
| Safety Zone | |
| Longitudinal (m) | 5 |
| Lateral (m) | 0.5 |
| Lanes | |
| Minimum LaneWidth (m) | 3 (2.5) |
| Two-way Roadway Width (m) | 5 |

Note:
 A. 45 degree taper is required at active temporary traffic controlled layouts with cones at 1m centres.
 B. Cone spacing shown is the maximum permitted. Where geometry or any other site specific reason dictates the spacing shall be reduced accordingly.
 C. The optimum lane width for all classes of vehicles is 3.3m. This may be reduced to a minimum of 3.0m. Below this, HGVs and buses must be marshalled past the works. The absolute minimum lane width, if only cars and light vehicles are present, is 2.5m. Refer to Chapter 8, Paragraphs 8.4.3.1 to 8.4.3.3.

LEGEND:

- DIVERSION ROUTE
- WORK/PLANT AREA
- SAFETY AREA
- SITE BARRIER
- CONES
- SIGN LOCATION & ORIENTATION
- BARRIER BOARD

GMC Utilities Group Ltd, GMC House,
 Millenium Business Park, Cappagh Road,
 Ballycoolin, Dublin 11, Ireland.
 Tel: +353 (0)1 864 9800
 Email: info@gmcirl.com

Project ; IW First Fix Repair
Location ; Berbera 9 Barnhill Road R829 Dalkey Dublin
TM Method ; Road Closure / Site Layout
Designer ; D.Gough **Drawn ;** D.Gough
Date ; 30/01/2023
Scale ; NTS
TMP Guide Reference ; **TMP-001**
Dwg Number ; GMC-TMP-13125-REV00

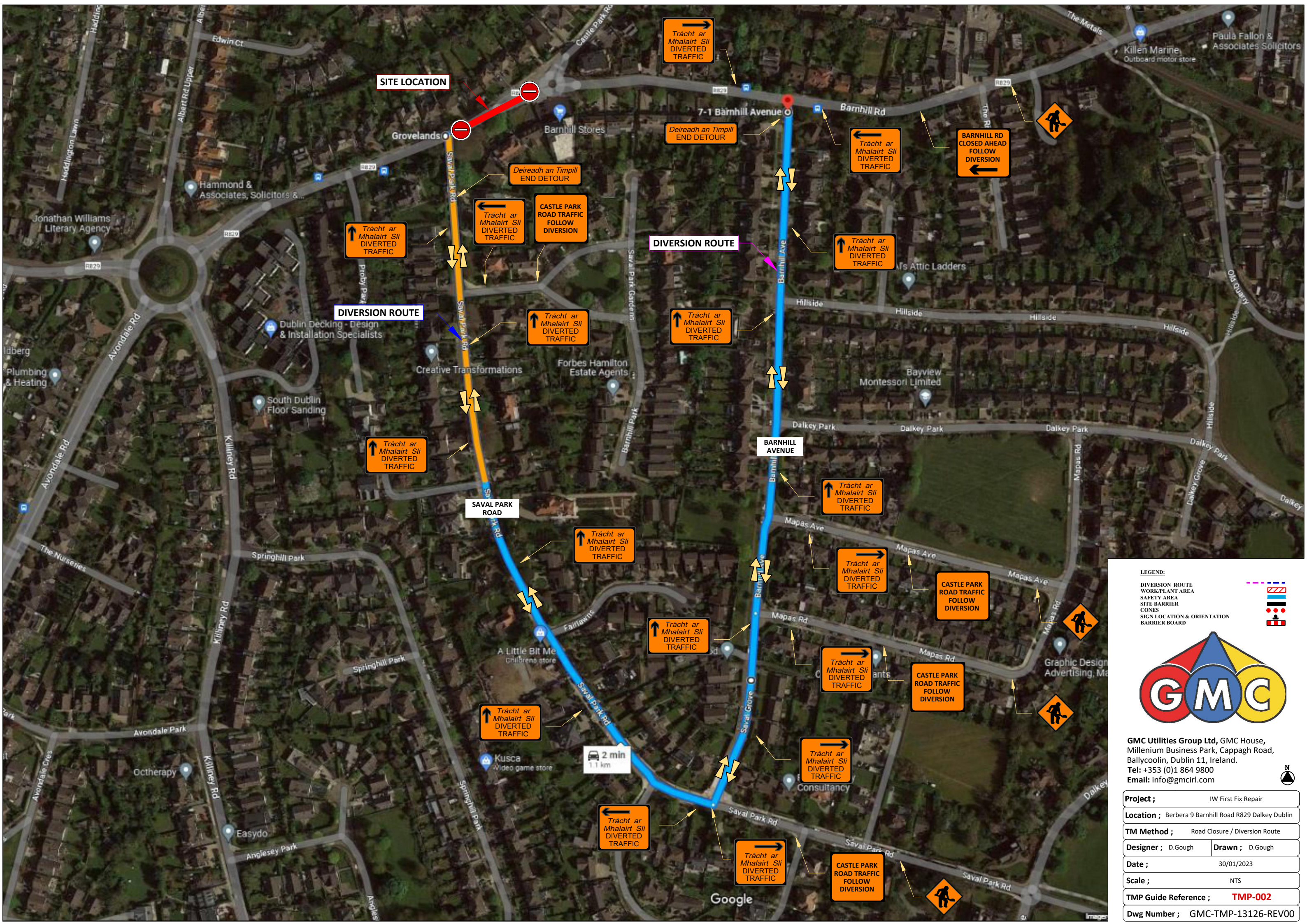

SITE LOCATION

DIVERSION ROUTE

DIVERSION ROUTE

BARNHILL AVENUE

SAVAL PARK ROAD

- LEGEND:**
- DIVERSION ROUTE
 - WORK/PLANT AREA
 - SAFETY AREA
 - SITE BARRIER
 - CONES
 - SIGN LOCATION & ORIENTATION
 - BARRIER BOARD

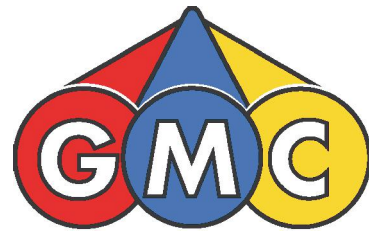

GMC Utilities Group Ltd, GMC House,
Millenium Business Park, Cappagh Road,
Ballycoolin, Dublin 11, Ireland.
Tel: +353 (0)1 864 9800
Email: info@gmcirl.com

| | |
|------------------------------|--|
| Project ; | IW First Fix Repair |
| Location ; | Berbera 9 Barnhill Road R829 Dalkey Dublin |
| TM Method ; | Road Closure / Diversion Route |
| Designer ; | D.Gough |
| Drawn ; | D.Gough |
| Date ; | 30/01/2023 |
| Scale ; | NTS |
| TMP Guide Reference ; | TMP-002 |
| Dwg Number ; | GMC-TMP-13126-REV00 |

2 min
1.1 km