

OBR100 Claremont Villas, Glenageary

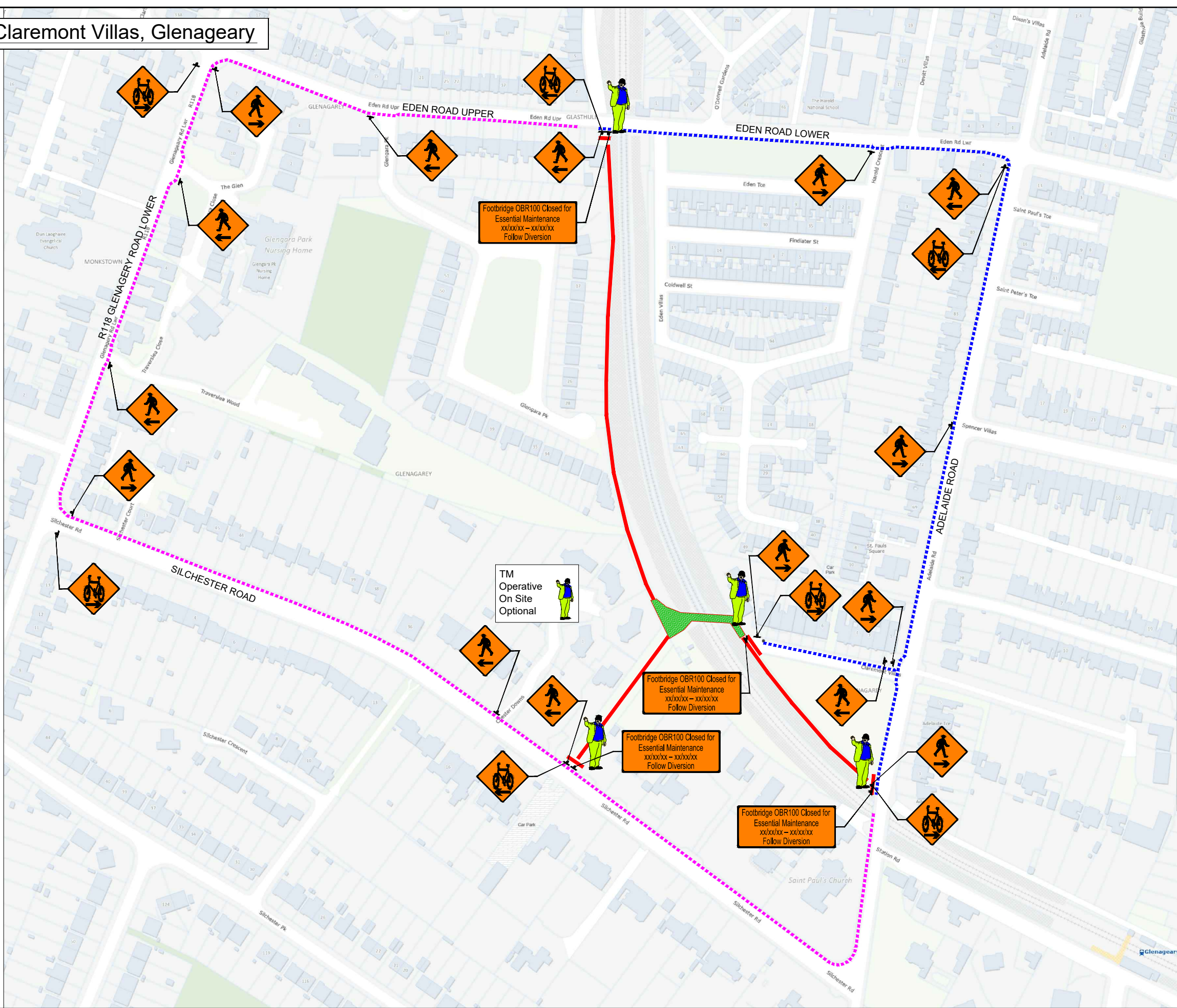

Designs Parameters:  
Type A Works, Single Carriageway  
Level 1(iii), Speed Limit 50km/h

DESIGN PARAMETERS	
ROAD LEVEL/SUB-LEVEL:	1(iii)
ROAD SPEED LIMIT:	50km/h
WORKS TYPE:	A
NUMBER OF ADVANCED SIGNAGE:	2
DISTANCE BETWEEN SIGNS:	20m
SIGN VISIBILITY:	50m
MINIMUM SIGN SIZE:	600mm
LONGITUDINAL SAFETY ZONE:	5m
LATERAL SAFETY ZONE:	0.5m
TAPER CONE SPACING:	3m
LONGITUDINAL CONE SPACING:	3m
TAPER LENGTH at LANE:	1 in 5
TAPER LENGTH at H/S:	1 in 5
LAMP SPACING at TAPER:	6m
LAMP SPACING at LONGITUDINAL:	6m
MINIMUM CONE SIZE:	750mm
MINIMUM LANE WIDTH:	3.0m
TRAFFIC MANAGEMENT SYSTEM:	

General Notes:

1. All signs to be in accordance with Chapter 8 of TSM and TTM Design Guidance Document 2019.
2. Signs to be placed so as not to cause hazard to road users and pedestrians.
3. Safety Zones to be in accordance with Chapter 8 and maintained at all times.
4. All necessary consultation, liaison and approvals will have taken place before installation.
5. Any changes to the TM Plan undertaken on site must be communicated to and approved by the Designer and notified to the PSDP and PSCS.

Duties and Responsibilities:

1. The Designer has designed the attached TTM plan with all the best available information available at the time of design. Should any further information become applicable it should be communicated to the designer for review and inclusion in the design as necessary.
2. It is the client's responsibility to employ a competent person to ensure that the scheme is installed safely.
3. For safe and consistent methods of TTM installation the installer of the scheme should as a minimum refer to the DTTaS documents "Temporary Traffic Management Operations Guidance Parts 0, 1, 2 & 3" as appropriate. This should be carried out in addition to and in combination with the installers own method statement, risk assessment and SOP's.

Site Specific Notes:

Legend:

- Works Area
- Footpath Closed
- Safety zone
- Traffic Cones
- Pedestrians
- Pedestrian Barrier
- Sign Symbol

Ordnance Survey Ireland Licence No. EN 0063609  
© Ordnance Survey Ireland/Government of Ireland



Client:

Project Title:  
Pedestrian Bridge Works OBR100  
Claremont Villas, Glenageary

Drawing Title:  
Temporary Traffic Management Layout  
for Bridge Closure and Diversion

Revision Details Box

Rev. No.	Comments

Detail Box

Drawn:	Scale:	Drawing no.:
PB	not to scale	TMD/2025R/2258/001
Approved:	Date:	Rev:
JF	02.01.2024	00