

# THE NATIONAL SPRING CLEAN ALL YOU NEED TO KNOW

The following headings should provide you with all the information you need to run a successful Spring Clean event.

## The Basics

### How to Organise an Event

1. Pick the area you want to clean-up
2. Pick a date/dates when the your event is going to take place
3. Register your event with An Taisce at [www.nationalspringclean.org](http://www.nationalspringclean.org) or by telephone – 01 4002219. You will then be sent a clean-up kit.
4. Inform as many different members of your wider community about the event as possible. This pack contains an NSC poster which can be copied and has a space for you to enter details of your event. Be creative in your advertising!
5. Contact your Local Authority; let them know the date and location of your clean-up. They will assist you with the efficient management of all rubbish and recyclables after the event.

Contact details for Local Authorities can be found on pages 4 and 5 of this booklet and online at: <http://www.environ.ie/en/LocalGovernment/LocalGovernmentAdministration/LocalAuthorities/>

Your Local authority may also be able to help by providing additional clean-up equipment such as; bags; gloves and litter pickers.

## Health and Safety

The following health and safety measures should be adhered to when organising an event.

### 1. Risk Assessment

Carry out a risk assessment of your chosen site before the event. This is an examination of the possible risks that could cause harm to your volunteers. You should look for the following hazards:

- Unidentified cans or canisters, oil drums, poisons, insecticides, clinical waste, other hazardous substances, broken glass, condoms, syringes, etc.
- Deep or fast flowing water, dangerous currents or tides, steep, slippery or unstable banks, sharp rocks, mud holes, derelict buildings, electric fences etc.

For each hazard identified you can decide what precautions are needed

If you do find any dangerous items make a note of their location and inform the local authority who will pick them up prior to your event.



## 2. Working with Children

If children are involved in your event, they must be supervised at all times – no more than eight children to one adult is advisable.

## 3. Working near Water

- Liaise with appropriate bodies, e.g. Environmental Protection Agency, local angling or water sports clubs, and lifeguards to check whether there are any possible hazards.
- Do not plan the clean-up near deep mud, steep, slippery or crumbling banks, or polluted water.
- Check the depth of water where possible, as well as times of tides and fluctuations of flow.
- Ensure that non-swimmers and children keep away from the water's edge.
- Ensure there is a trained lifesaver present.
- Ensure that people wearing waders are accompanied by a partner with a safety line.
- Weil's Disease is a bacterial disease which is spread mainly by the urine of infected animals, especially rats. To prevent the spread of the disease volunteers should wear strong waterproof boots and gloves. Any cuts or grazes should be carefully covered up before the clean-up event with waterproof plasters.

## 4. Working near Roads and Lay-bys

- Initially, restrict groups to work on footpaths and verges with a 60 KM per hour speed limit or below.
- Children under 12 should not pick up litter by the roadside.
- Volunteers should wear hi-visibility clothing and warning signs should be placed at either end of the stretch of road while work is in progress.

## 5. On the Day

Appoint an event coordinator who will:

- Brief on emergency procedures;
  - Organise volunteers into teams;
  - Distribute and collect equipment;
  - Specify where rubbish should be left.
- All Participants should wear gloves.
  - Hands should be washed before and after handling litter. Do not eat or drink without washing hands thoroughly.
  - A first aid kit should be present at the clean-up



## 6. Insurance

Groups registered for the National Spring Clean with An Taisce are automatically covered by An Taisce's Public Liability Insurance policy. Public Liability covers the organizer(s) of a clean-up in the event of an accident occurring to a volunteer or a member of the public or their property that may be attributed to the organiser's negligence, or to that of one of their volunteers.

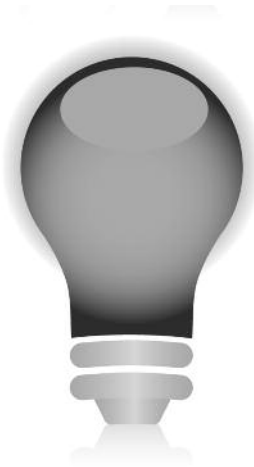

## Recycling Initiative

Recycling is an important part of the National spring clean. Separate colour-coded bags are provided for the collection and segregation of recyclable cans and plastic bottles. Please ensure these bags are used correctly.

**Blue Bags** – Food and drink cans only, no paint pots

**Yellow Bags** – Plastic bottles. No polystyrene, no yogurt bottle/pots, no DIY chemical bottles.

N.B. Dún Laoghaire-Rathdown and Sligo County Councils will be providing their own branded bags for this year's National Spring Clean campaign. If you live in either of these Local Authority areas you will not receive bags with your clean-up kit. To obtain bags for your event please contact your Local Authority; contact details are provided on page 4 of this booklet.



## Protect Local Biodiversity

Clean-up events should not adversely affect local biodiversity (flora and fauna)

- Be considerate to wildlife if working in countryside, parks, woodland, around shrubbery, hedgerows, ditches or open spaces. April is the time of year when many animals are nesting and plants are making new growth, so extra care needs to be taken
- Keep gates closed and avoid cleaning up natural materials such as logs, stones and weeds. They may look untidy but they are often home to animals and birds.

## Promoting Your Event

Clean-ups can be excellent community events and make great local stories.

An Taisce will contact local media with details of every event which we have information on. In order to increase the chance of the media picking up on your event please give us as much information on your event as possible when registering or later when you have more information. If you have provided us with an email contact when registering we will email you asking for any details you may have of your event. If you have registered on-line you will have the capability to fill in details about your event at anytime on our website.

The more imaginative your events the more likely it will be covered.

### Find us on Facebook, Twitter and Flickr

For the latest updates on what's going on throughout the country during this year's National Spring Clean or to let everyone know all about your clean up event find us on Facebook and Twitter. Check out photos from previous campaigns on the new National Spring Clean Flickr page. For further details log on to [www.nationalspringclean.org](http://www.nationalspringclean.org)

# Local Authority Contact List

Don't forget to contact your Local Authority in advance of your event and let them know the planned date and location of your clean-up. They will assist you with the efficient management of rubbish and recyclables collected during the event and may also be in a position to provide your group with additional clean-up materials if required.

<b>Local Authority</b>	<b>Contact Number</b>
Carlow County Council	059 9136210 / 059 9136203
Cavan County Council	049 4378406
Clare County Council	065 6821616
Cork City Council	021 4966222 Ext 4308
Cork County Council – North	022 30456 / 30459
Cork County Council – South	021 4285518
Cork County Council – West	028 21299
Cork County Council – All Areas	You may also contact your local area office or town council for details of facilities available to registered groups.
Donegal County Council	074 9176276
Dublin City Council – Central Area Office	1800 248 348
Dublin City Council – North Central Area	01 8166715
Dublin City Council – North West Area Office	01 2225400
Dublin City Council – South East Area Office	01 2223934
Dublin City Council – South Central Area Office	01 2225183
<b>Dún Laoghaire Rathdown County Council</b>	
Dún Laoghaire-Rathdown will be providing their own branded bags for this year's National Spring Clean campaign. If you are conducting a clean-up in this area you will not have received bags with your clean-up kit. To obtain bags for your event please contact Dún Laoghaire Rathdown Co. Co. on 01 2054817	
Fingal County Council	01-8905000 ask for the Operations Department.
South Dublin County Council	(01) 414 9000
Galway City Council	091 536960
Galway County Council	Contact Galway County Council on 091-476482 before commencing your clean-up, pre-paid bags to be provided in situations where collections aren't possible
Kerry County Council	066 7162000
Kildare County Council	045 980588

Don't forget to contact your Local Authority in advance of your event and let them know the planned date and location of your clean-up. They will assist you with the efficient management of rubbish and recyclables collected during the event and may also be in a position to provide your group with additional clean-up materials if required.

<b>Local Authority</b>	<b>Contact Number</b>
Kilkenny County Council/ Kilkenny Borough Council	056-7794470
Laois County Council	057 86 74330
Leitrim County Council	1890 205 205
Limerick City Council	061 407190
Limerick County Council	061-496192, 061-496214, 061-496225, 061-496577, 061- 496386, 061-496279
Longford County Council	043 - 3343367
Louth County Council	042 935 3130
Mayo County Council	094 9024444
Meath County Council	046-9097200
Monaghan County Council	047 30592 / 047 30593
North Tipperary County Council	067 44784
South Tipperary County Council	1800 20 26 27
Offaly County Council	057 9357403
Roscommon County Council	090 6636262
Sligo Borough Council	071 9114400
<b>Sligo County Council</b>	
Please note that if you reside outside of the Sligo Borough boundary, you will not have received bags with your clean-up kit. Once you have registered with An Taisce you can go along to Sligo Co. Co. offices at Riverside to collect bags for your planned clean-up. Community Groups can avail of clear bags which will be collected by Sligo Co. Co., and School Groups will be given prepaid bags that can be put out on their normal waste collection day. For more info on this you can contact Sligo Co. Co. on 071 9111901 or email <a href="mailto:mclerkin@sligococo.ie">mclerkin@sligococo.ie</a>	
Waterford City Council	051 849938
Waterford County Council	058 22000 / 1800 201 501
Westmeath County Council	044 93 32125/32226
Wexford County Council	053 9196313
Wicklow County Council	1890 222276 or <a href="mailto:eao@wicklowcoco.ie">eao@wicklowcoco.ie</a>

# How to get the information you need

**ENFO is Ireland's Public information service on environmental matters, including litter and waste management. The service provides public access to wide-ranging and authoritative information on the Environment.**

ENFO a service of the Department of the Environment, Heritage and Local Government, provides high quality, user-friendly content and a gateway to the many existing online environmental resources. In addition to the online facility, improvements to the ENFO service include hosting of environmental exhibitions across the 350 library branches nationwide and access to the ENFO library collection on a countrywide basis by way of borrowing. For more information log onto [www.enfo.ie](http://www.enfo.ie)



## How to recycle

### Remember the 3 Rs: Reduce - Reuse - Recycle

#### Minimisation of Waste

The best way to reduce the impact of waste on the environment is to avoid producing it in the first place. Waste generation is on the increase. Household and commercial waste increased by over 600,000 tonnes over the past decade to nearly 3.4 million tonnes.

**YOU** can make a positive difference by thinking about the impact of how you shop:

- Avoid products that use excess packaging.
- Buy refills where possible. If practical, buy one large container rather than several little ones – it uses less packaging and is cheaper too. Many printer cartridges can now be refilled in special shops or donated to charity for recycling.
- Choose loose fruit and vegetables, avoid pre-packaged ones.

- Buy concentrated products where possible, e.g. concentrated washing detergent - these use less packaging.

#### Reuse

- Avoid using polystyrene cups that will be thrown away, instead use washable mugs.
- Use cloth napkins and dishcloths instead of paper ones.
- Use rechargeable batteries to save yourself money and to keep toxic metals found in some batteries out of the waste stream.
- SNUB - Say No to Unwanted Bags. Always use a reusable shopping bag, or reuse plastic bags. Don't accept bags you don't need!

## Recycle

The combined recycling rate of household and commercial waste (municipal waste) in 2008 was 37.5%; exceeding the national target of 35% recycling of municipal waste by 2013. A revised target will be required in order to build on this success. Recycling helps reduce the need for new materials to be produced, which in turn helps to protect scarce natural resources. Recycling also reduces the amount going to landfill sites - manmade holes in the ground where waste is buried. Space in landfills is running out fast. It was estimated in 2008 that the total combined landfill capacity of Ireland's 29 municipal landfills is only twelve years.

- Milk bottles - the average milk bottle is reused many times before it is recycled. Rinse and then return them to your milkman.
- Old clothes - take your old clothes and shoes to charity shops, jumble sales or clothes banks to be reused.
- Aluminium foil - clean, well-compacted aluminium foil is a valuable source of income for many charity shops. Check with your local charity shop to see if they accept washed bottle tops and tin foil.
- Aluminium cans - almost 60% of the cans used in Ireland each year are made of aluminium and they are 100% recyclable. Up to 95% of the energy used in primary aluminium production is saved by recycling. Take your cans to recycling banks. Crushing your used cans will save space in the kitchen and means that more can be squeezed into the recycling bank.
- Plastic bottles – most household plastic packaging is recyclable. Most plastic containers are coded by numbers 1 to 6 or by letters (such as PET, PETE, LDPE, PP, PS) according to their plastic type. Check with your local recycling centre for which types of plastic they take. Wash, Squash and

remove the lids and bring your clean bottles to your nearest recycling centre/civic amenity site for recycling. No Yogurt cartons, spread tubs, Polystyrene, DIY or Chemical bottles.

- Glass – do not mix colours of glass, as colour contamination destroys the quality of recycled material. Blue glass should go into the green glass container. Recycle all household bottles and jars. No Ceramic, Pyrex, Cookware or glassware should be placed in recycling banks.
- Recycling facilities - make full use of the available recycling facilities in your area. If you don't know where they are, contact your local authority who will provide you with a list or visit [www.repak.ie](http://www.repak.ie). Tetra Pak cartons, Waste electrical equipment and white goods, computers, textiles, timber, metals, tyres, batteries, cds and videos and many other items can be brought to most Civic Amenity recycling centres. Check what items your local recycling centres take with your local authority. Phones and ink cartridges can be given to a range of charities for recycling. Ink cartridges can also be refilled in special shops or by various organisations nationwide.



- It is especially important to remember to recycle during your NSC clean-up event. That way, not only are you removing the litter from your area, but you are also ensuring that recyclable litter does not simply end up at landfill. If practical, maybe one person on your litter-pick can collect cans, another plastics, another paper etc. At the end of your clean-up event, be sure to bring your recyclable litter to your nearest recycling facility – otherwise it may just end up as litter again!

To encourage recycling in your home introduce separate bins for Rubbish, Dry Recyclables and Compost. Store used glass, plastic bottles and cans in your garden shed or garage and make one trip for all materials to your nearest recycling centre. For more information on recycling log on to [www.recyclemore.ie](http://www.recyclemore.ie)

## Composting

- If you have a garden, why not start a compost heap using kitchen food and garden waste? Organic materials recycled in this way provide valuable nutrients for your soil. Compost also improves the soil structure and encourages a more vigorous root system.
- Don't use cooked foods, especially cooked meats, to make compost.
- If you have a small garden, a compost bin or a wormery composter takes up less space and produces ready to use compost more quickly than a traditional compost heap. Try starting a community compost heap with your friends and neighbours.





# National Spring Clean Youth Activities

**The Youth Activities Pack** is an educational resource aimed at teachers, youth leaders and young people, which can be downloaded at: <http://www.nationalspringclean.org/downloads.php?pagetype=materials>

**The activities** should raise discussion about litter, the problem and solutions as well as develop an awareness of our collective responsibility for litter.

**The Activity Cards** can be used across the curriculum for English, Mathematics, science and Art and for Social and Personal studies – linking in with the idea of care in the community, moral responsibility and positive action. National Spring Clean is an approved 'Environmental Action Project' for the Civil, Social and Political Education course and an approved 'Day of Action' for the Green-Schools programme. The following two pages provide sample content which is available to download in full online.

**An Taisce** produce an activity pack for Youth and Uniform Groups which is also available to download at: <http://www.nationalspringclean.org/downloads.php?pagetype=materials>

**The Youth Pack** is sponsored by The Wrigley Company Ltd.



38th Cub Scouts at Kenure Woods, Rush, Co Dublin

# Check out the Grot-Spots

- What is litter?
- Do you know where people should put litter?
- Do you have litter bins in your school or youth club?
- Does everyone use litter bins?



## Think about your city, town or village. Are there any places that are full of litter?

A really messy area can be called a **'grot-spot'**! Talk about litter with your group. Draw a **'mind map'** or **'spider diagram'** with your teacher or leader. Write all your own thoughts and ideas using bright coloured pens to make it really eye catching. Stick your finished **'mind map'** on the wall of your classroom or youth club to remind you of your thoughts.

## Think about:

- Who drops litter?
- Where do you think most litter is dropped?
- When is litter dropped?

## Ask your teacher or leader to photocopy a street map of your area.

- Can you find your street?
- Where is your school/youth club?
- Are there any grot-spots you can think of?

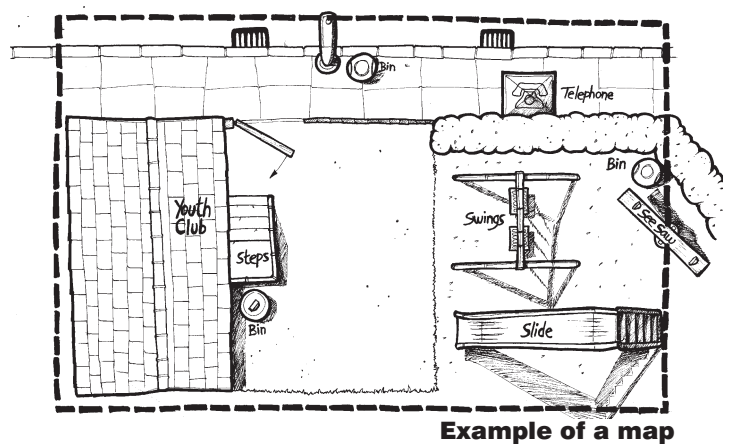

Now draw a simple map of your school or youth club following the example given. Ask your teacher or leader to help. Are there any grot-spots? Colour them in. Be sure you draw in all the litter bins. Colour them in bright yellow.

---

# Litter and the Law

## Know your responsibilities for taking action against litter pollution

Taken from the ENFO publication “LM1 Litter Management”

---



### Fines

Leaving or throwing litter in a public place is an offence which can be subject to an on-the-spot fine of £150 or a maximum fine of £3,000 in court. The definition of litter is quite wide and extends beyond casual pieces of paper or cigarette ends to anything large or small which is, or is likely to become, unsightly.

A person convicted of a litter offence may also be required by the court to pay the local authority's costs and expenses in investigating the offence and bringing the prosecution.

### Public Places

If you are the owner or the person responsible for a place to which the public has access you are obliged to keep the place litter free, regardless of how the litter got there. This applies to any public place which may include the precincts of a shopping centre, a school campus, a public park, a train or bus station.

### Private Property

The owner or occupier of property which can be seen from a public place is obliged to keep it free of litter. Basically, any outdoor area on your property that is visible from a public place must be kept free of litter.

### Litter Black Spots

Where litter has accumulated on property for whatever reason and the litter is visible from a public place, the local authority can issue a notice to the owner or occupier requiring the prompt removal of the litter. Such a notice can also set down precautionary measures to be put in place to prevent a reoccurrence.

If a property owner or occupier fails or refuses to do everything that has been requested, the local authority has the power to do whatever is necessary itself and require the owner or occupier to pay all of the costs involved.

### Illegal Dumping

The litter laws have increased the powers of local authorities to combat the problem of illegal dumping of refuse and rubbish. Where a local authority finds material that is illegally dumped and establishes the identity of the owner of the material, that person will have a case to answer without necessarily having to be caught in the act.

Extra powers are also available to local authorities to require a householder or business operator to indicate how and where they are disposing of their waste. This is particularly relevant if the householder or business owner is not availing of a refuse collection service or bringing their waste to an authorised disposal facility.

If you see someone dumping illegally, report the matter to your local authority who will investigate and take any necessary enforcement action.

### Major Events

The promoters or organisers of major events are required to ensure that they have litter control measures in place at the venue and in the surrounding vicinity before, during and after the event. This applies to football matches and other social and sporting events at which large crowds attend. It is possible that this task can be undertaken by the local authority but the promoter/organiser must bear the costs involved.

## Mobile Food Outlets

Operators of mobile food outlets selling fast food or beverages, or other outlets such as those selling farm produce are obliged to provide suitable litter bins in the vicinity of their outlets. Also, they must clean-up any litter arising from the operation of their outlets within a radius of 100 metres from their outlet.

## Dog Fouling

Dog owners must now remove their pets' waste from public places and dispose of it in a proper manner.

This obligation applies to the following places:

- public roads and footpaths
- areas around shopping centres
- school/sports grounds
- beaches
- the immediate area surrounding another person's house.

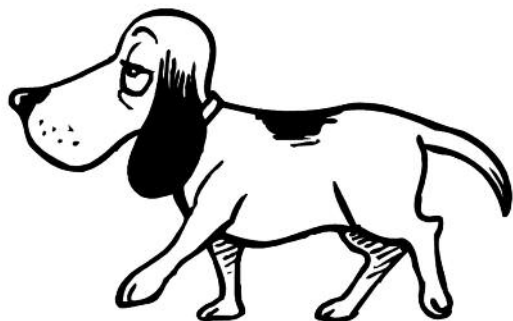

## Posters and Signs

The law forbids the putting up of posters/signs on poles or on other structures in public places unless you have the written permission of the owner of the pole or other structure in advance of putting up the posters/signs.

## Advertising Flyers

The placing of advertising leaflets on car windscreens is prohibited and if you are proposing to distribute advertising leaflets in the street, you should first check with the local authority to see if they have introduced any local litter restrictions, which they are entitled to do.

## Presenting your Refuse for Collection

Taking a few small precautions in the way you present your refuse for collection will help enormously in preventing the creation of litter. If you are not already using a wheelie-bin or ordinary refuse bin, you should use strong plastic bags and avoid using lightweight supermarket type bags. You should put out refuse for collection on the morning of the collection and not on the day or night before. The longer it is left out for collection the more likely it is to attract the unwanted attention of dogs, cats and birds.

It is an offence to dispose of your household refuse in street litter bins.

## Who enforces the litter laws?

Local authorities are responsible for implementing the litter laws in their own areas. This means they are responsible for the prevention and control of litter and they have the power to take enforcement action against individuals who break or ignore these laws. Gardai also have the power to issue on the spot fines for litter offences.

# An Taisce Environmental Awareness Initiatives

---

## Green-Schools

---



**Green-Schools** is an International environmental education programme that aims to acknowledge and encourage whole school action for the environment. Green-Schools offers a well-defined, controllable way to take environmental issues from the curriculum and apply them to the day-to-day running of a school. Pupils identify environmental problems they are responsible for and try to find ways to solve them. Green-Schools is both a programme and an award scheme. The programme can be adopted by any school using the guidelines given in the handbook. The award will be given to schools that complete the seven steps of the programme:

1. Green-Schools Committee.
2. Environmental Review.
3. Action Plan.
4. Monitoring and Evaluation.
5. Curriculum Work.
6. Informing and involving the Wider Community.
7. Green-Code.

There are currently 52 countries globally operating the programme, with approximately 32,000 schools registered and working towards achieving the prestigious Green Flag. In Ireland over 3,700 schools, or about 89% of schools, are registered as Green-Schools: of these, 2577 schools have been awarded the coveted green flag. Initially schools concentrate on the themes of Litter and Waste. Subsequent themes are Energy, Water, Travel, Biodiversity and Global Citizenship.

Green-Schools is operated in Ireland in partnership with local authorities. 33 local authorities participate in the scheme. Green-Schools is kindly sponsored by Repak, the Wrigley Company, Trocaire, Irish Aid, the National Parks and Wildlife Service, the National Transport Authority and the Department of Transport.

It is calculated that a combined overall minimum saving of approximately €4 million was achieved by awarded schools working on the Green-Schools programme during the 2010-2011 academic year. This was achieved through diversion of waste to landfill, reduction in energy and water consumption, use of transport fuel and reduced CO<sub>2</sub> emissions. Calculating the cumulative effect of the programme in the households of Green-Schools students it is estimated that an overall saving of in the region €8 million was achieved.

Direct Performance outputs for Green-Schools for 2011 – 2012 academic year include:

- 7,400 tonnes of waste diverted from landfill
- 57 million units of electricity saved
- 164 million litres of drinking water saved and a similar amount of waste water not generated
- 650,000 litres of transport fuel saved

Indirect impact and outputs through the home and the community could be a factor of 5-7 times these. If you would like your school to get involved in Green-Schools, or if you would like more information about the programme, please contact:

**Cathy Baxter, Greens-Schools Manager,  
Environmental Education Unit, An Taisce,  
Unit 5a Swift's Alley, Francis Street, Dublin 8.  
Tel: 01 400 2222 Fax: 01-4002285  
E-mail: [greenschools@antaisce.org](mailto:greenschools@antaisce.org)  
Website: [www.greenschoolsireland.org](http://www.greenschoolsireland.org)**

---

## Learning about Forests

---



**Learning about Forests** is an international programme that aims to encourage schools, classes and teachers to use forests for educational activities. The programme works as an internet-based network between participating countries. Over ten countries across Europe are currently actively involved.

In Ireland the programme was piloted during the 2001-2002 school year in order to assess the possibilities and feasibility of the LEAF programme in an Irish educational context.

Check out the international Learning About Forests website at **[www.learningaboutforests.org](http://www.learningaboutforests.org)** For further information on Learning About Forests, contact:

**Environmental Education Unit,  
An Taisce, 5a Swift's Alley, Francis Street, Dublin 8.  
Tel: 01 400 2202  
Fax: 01 4002285  
E-mail: [education@antaisce.org](mailto:education@antaisce.org)**

**Green Communities** is an environmental programme aimed at enhancing local biodiversity and positively affecting climate change at a local level. An Taisce will work with new and existing volunteer groups to look at how their activities can be focused to improve habitats and wildlife in their local areas and how they can minimise their carbon output.

Examples of typical Green Communities activities include the following:

- Development of a community garden to promote local food production and to bring communities together
- Development of a wildlife area
- Regular clean ups and conservation work (e.g. marram grass planting)
- Sensitive clearance work (e.g. clearing a neglected area of land so that it provides a green space for people to enjoy and an enhanced habitat for wildlife)
- Erection and maintenance of bird, bat, hedgehog, owl etc boxes
- Management of invasive species such as Japanese Knotweed, Rhododendron, etc

An Taisce wishes to establish a network of Community Groups throughout the country which can establish good communications and disseminate methods of best practice.

**Robert Moss**  
**Green Communities, An Taisce Education Unit,**  
**5a Swifts Alley, Francis St., Dublin 8.**  
**Tel: 01 4002212**  
**Fax: 01 4002285**  
**Email: [rmoss@eeu.antaisce.org](mailto:rmoss@eeu.antaisce.org)**

The **Blue Flag** is operated in Ireland by An Taisce-The National Trust for Ireland on behalf of the Foundation for Environmental Education (FEE). The Blue Flag is one of the world's most recognised eco-labels. Beaches and marinas that achieve this accolade must comply with a specific set of criteria relating to water quality, information provision, environmental education, safety and beach management. At beaches the bathing water must be comply with the excellent standard in accordance with the EU Bathing Water Directive. The Blue Flag programme is funded in Ireland by the Department of the Environment, Community & Local Government.

The award originated in France in 1985 when French coastal Local Authorities were awarded with the Blue Flag for compliance with sewage treatment and bathing water quality criteria. In 1987, the "European Year of the Environment", the Foundation for Environmental Education in Europe (FEEE) presented the French concept to the European Commission, and the Blue Flag Programme was launched as one of the year's community activities. In addition to sewage treatment and bathing water quality, criteria for obtaining a Blue Flag on a European level included other areas of environmental management, such as waste management and coastal planning and protection. Marinas were also eligible for the award. In 1987 the Blue Flag was awarded to 244 beaches and 208 marinas in ten European countries. In 2001 FEE became a global organisation and changed its name from FEEE to FEE (Foundation for Environmental Education). Since then, many countries outside Europe have joined the Blue Flag Programme. South Africa, Morocco, Tunisia, New Zealand, Brazil, Canada and the Caribbean are all participating in the Blue Flag. Today, there are 3,203 blue flag beaches and 646 blue flag marinas around the world! The Blue Flag has been operating in Ireland since 1988 when 19 beaches and 2 marinas were awarded blue flags. Since then the programme has grown from strength to strength with 84 beaches and 3 marinas achieving the accolade in 2012.

If you would like to find out more about the Blue Flag please contact:

**Annabel FitzGerald**  
**Coastal Programmes Manager,**  
**Environmental Education Unit, An Taisce,**  
**5a Swifts Alley, Francis Street, Dublin 8.**  
**Telephone: +353 1 4002210 / +353 1 4002221**  
**Email: [afitzgerald@eeu.antaisce.org](mailto:afitzgerald@eeu.antaisce.org)**  
**Website: [www.blueflagireland.org](http://www.blueflagireland.org)**



---

## Clean Coasts - Join the Movement for Litter Free Seas!

---



**Clean Coasts** engages communities in protecting our beaches, seas and marine life. The programme is funded by the Department of the Environment Community and Local Government. Clean Coasts aims;

- To encourage and facilitate coastal clean-up initiatives in Ireland which make a tangible and immediate improvement in local environmental quality.
- To celebrate, award and highlight success where improvements are delivered through beach awards and Clean Coasts Merit awards.
- To create a national coalition of voluntary groups and individuals, public sector and industry, pledging and acting to help keep the Irish coastline litter free.

### Clean Coasts in Numbers 2012

- 285 active Clean Coasts groups
- 10,000 volunteers
- 700 coastal clean ups
- 245,894 litter items removed from the Irish coast
- 1,419 km of coast cleaned
- 3,000 Clean Coasts Photography competition entries
- 9 Clean Coasts Merit Awards

**If you would like to join Clean Coasts**, go to [www.cleancoasts.org](http://www.cleancoasts.org). Find out how you can join a Clean Coasts Group or set up your own.

### Take part in Coca-Cola Clean Coasts Week

10<sup>th</sup> – 17<sup>th</sup> May

[www.cleancoastweek.ie](http://www.cleancoastweek.ie) or call 01 4002210

### Take part in the BIG BEACH CLEAN 3<sup>rd</sup> weekend in September

Be part of the world's largest marine litter survey!

Go to [www.cleancoasts.org/bigbeachclean](http://www.cleancoasts.org/bigbeachclean) or call 014002210

### Join our social network

Facebook.com/CleanCoasts

Twitter.com/CleanCoasts

Spread the word – tell your family and friends about Clean Coasts

### Annabel FitzGerald

Coastal Programmes Manager,

Environmental Education Unit, An Taisce,  
5a Swifts Alley, Francis Street, Dublin 8.

Telephone: +353 1 4002210 / +353 1 4002221

Fax : +353 1 4002285

Email: [afitzgerald@eeu.antaisce.org](mailto:afitzgerald@eeu.antaisce.org)

Websites: [www.cleancoastsireland.org](http://www.cleancoastsireland.org)

[www.cleancoastweek.ie](http://www.cleancoastweek.ie)



'The Holy Ground' by Dave Keeley, Clean Coasts Photography Completion Photograph of the Year

---

## Neat Streets



---

**Neat Streets** is an anti-litter programme for Secondary Schools across Ireland. It involves students working with their peers to develop initiatives to tackle litter and waste in their schools and local areas.

The programme is designed to facilitate and develop leadership, project management, citizenship and communication skills among students through the design and implementation of an anti-litter campaign. Participants are encouraged to initially assess and measure litter levels and policy within their schools and then to engage the wider community in implementing a litter management plan for the local area.

Over the period of the programme An Taisce provides ongoing support, training and advice for schools. Schools also develop their own expertise and exchange information and experiences with other schools via forums, presentations, exchange visits and ICT.

Schools that successfully implement the Neat Streets programme over an academic year are presented with the Neat Streets award on completion of their programme.

For further details contact:

**Eoin Morton**  
**An Taisce Education Unit,**  
**5a Swift's Alley,**  
**Francis Street, Dublin 8.**  
**Tel: 01 4002202**  
**Fax: 01 4002285**  
**Email: emorton@eeu.antaisce.org**  
**Website: www.neatstreets.org**

Dundalk IT became the second Institute of Technology to be accredited with the prestigious International 'Green Flag' award, November 2012

---

## Green-Campus



---

The **Green-Campus Programme** is an evolution of Green-Schools (known internationally as Eco-Schools) which is a programme developed by the Foundation for Environmental Education (FEE). The Environmental Education Unit of An Taisce is the Irish National Operator for all programmes of FEE. The Green-Campus Programme has been in operation in Ireland since 2007. At present 24 Campuses are formally registered on the Programme and five of these have been awarded the Green Flag. The Programme encourages practical environmental education and the empowerment of campuses to become exemplar in environmental stewardship. Throughout the pilot research and subsequent work with tertiary education providers it was found that the environmental impact of the tertiary education sector is significant, yet rates of campus uptake of traditional environmental management systems are low. Stakeholder driven, bottom up approaches to environmental management as facilitated by Green-Campus has delivered benefits to the environment, campus management, students and learning, and to local and wider communities. It must be noted that the Green-Campus Programme does not reward specific environmental projects or implementation of a new technology instead it rewards long-term commitment to continuous improvement from the campus community.

For further details on the programme contact:

**Green-Campus,**  
**An Taisce Education Unit,**  
**5a Swift's Alley,**  
**Francis Street, Dublin 8.**  
**Tel: 01 4002202**  
**Email: greencampus@eeu.antaisce.org**  
**Website: www.greencampusireland.org**





**Greening Communities** is a national programme that seeks to shine a light on communities that are working for themselves to make their community a better place to live and work!

The Programme is a joint initiative of the Department of the Environment, Community and Local Government, the Environmental Protection Agency and An Taisce – the National Trust for Ireland. Greening Communities is designed to take an overarching look at the abundant active programmes and initiatives (e.g. Tidy Towns groups, Green-Schools, National Spring Clean, Transition Towns and the Smarter Travel programme) and celebrates the work being undertaken at community level throughout the country.

As part of the programme, we focus on particular communities, recording best practice (for positive environmental behaviour); identifying the needs of a community; and providing support to facilitate the growth of these Greening Communities.

The spread of this best practice is a core element of the programme, to maximise the positive steps being undertaken. The examples are growing in number as we explore all parts of the country at community and local authority level. The aim is to engage with programme operators, local authorities and community champions to advance the development of robust and interactive networks.

Keep track of us through our Facebook and website! Let us know what is happening in your community, maybe you have a story to tell?

**Brídín Mulhall**  
Greening Communities Coordinator,  
An Taisce Education Unit,  
5a Swift's Alley,  
Francis Street, Dublin 8.  
Tel: 01 4002229  
Email: [greeningcommunities@eeu.antaisce.org](mailto:greeningcommunities@eeu.antaisce.org)  
Website: [www.greeningcommunities.ie](http://www.greeningcommunities.ie)

**Green Home** is an action based environmental education programme funded by the EPA under the National Waste Prevention Programme and run by the Environmental Education Unit of An Taisce. The programme extends the successful Green Schools message into the households of the wider community. The programme supports householders as they take actions that reduce their impact on the environment while saving money on household bills.

The higher ideal is that Green Home participants will all contribute in a very positive way towards more sustainable living in Ireland. To date 60 schools and several community groups have received a Green Home award. The programme in 2012 has several thousand members and continues to grow and reach more households community groups and businesses with money saving tips and information on the programme themes of waste, energy, water and transport.

Any individual, business or community group can visit the website [www.greenhome.ie](http://www.greenhome.ie) become a member and learn about ways to save money and access current environmental information. Participants can fill out a simple online survey to see how green their home is. The programme is free of charge and it is envisaged that participation in the programme will also contribute towards building a stronger sense of community. The programme avails of the many benefits of 'New media', to include Facebook, Twitter and Flickr to disseminate the Green Home message and to engage with a wider audience across Ireland.

For further details on the programme contact:

**Dorothy Stewart**  
Green Home Programme Manager,  
An Taisce Education, 5a Swift's Alley,  
Francis Street, Dublin 8.  
Tel: 01 4002218 Fax: +353 1 4002285  
Email: [dstewart@eeu.antaisce.org](mailto:dstewart@eeu.antaisce.org)  
Website: [www.greenhome.ie](http://www.greenhome.ie)



---

## Young Reporters for the Environment

---



### Young Reporters for the Environment (YRE)

is a European-wide environmental education programme developed for secondary schools by the Foundation for Environmental Education.

The goal of YRE is for participants, aged 11-21, to investigate environmental issues and problems and report on them through written, photographic or video journalism, while investigating solutions.

Students can work as an entire class or as a small team to undertake a project on the environment. The projects must relate to one of the following themes:

- Agriculture
- Coastline
- Waste
- Cities
- Energy
- Water

With a national project, the students carry out a journalistic enquiry on a local environmental problem and become directly involved with the bodies or the individuals concerned. They then inform the regional public of their findings via the local media. This can be done through television, radio, newspapers or exhibitions.

The YRE project provides invaluable experience for students as they come into direct contact with the key players in their community. As well as activating an interest in the local environment, it improves their communication and journalistic skills and encourages team-work among the class.

For further information about Young Reporters for the Environment, contact:

**YRE Manager, Environmental  
Education Unit,  
An Taisce, 5a Swift's Alley,  
Francis Street, Dublin 8.  
Tel: 01-400 2202 Fax: 01-4002285  
E-mail: [yre@antaisce.org](mailto:yre@antaisce.org)  
Website: [www.antaisce.ie/education](http://www.antaisce.ie/education)**

---

## Irish Business Against Litter

---



The Environmental Education Unit of An Taisce has been commissioned by the **Irish Business Against Litter (IBAL)** group to carry out a series of Litter Surveys in the Republic of Ireland and in Northern Ireland. Irish Business Against Litter is an alliance of companies sharing a belief that continued economic prosperity – notably in the areas of tourism, food and direct foreign investment – is contingent on a clean, litter-free environment and that enforcement of litter laws, as opposed to public awareness campaigns, is the most effective means of ensuring this in our towns and cities.

The surveys take place in July and October each year, with Trim in County Meath emerging as the overall winner in 2011. IBAL have again commissioned An Taisce to run the anti-litter league in 2012. For further information on the Anti-Litter League please contact:

**For further information contact Dawn or Conor in  
Cullen Communications.**

**Tel 01 6689099/ 087 215 6942/086 8217211 or  
[dburke@cullencommunications.ie](mailto:dburke@cullencommunications.ie)**

---

## FEE

---



The Blue Flag Campaign, Green-Schools, Young Reporters for the Environment and Learning about Forests are initiatives of **FEE (Foundation for Environmental Education)** and are carried out by the member organisations of FEE in Europe. An Taisce – The National Trust for Ireland is the Irish member of FEE. Patricia Oliver is the co-ordinator of all FEE projects in Ireland.

**Visit the Projects Section of An Taisce's website;  
[www.antaisce.ie/education](http://www.antaisce.ie/education). Get the European  
perspective on the FEE initiatives at the FEE  
website: [www.fee-international.org](http://www.fee-international.org)**

### Working for Ireland's Future

We are Ireland's oldest and largest independent, wide-ranging environmental organisation with 27 voluntary associations throughout Ireland. In recent years Ireland's environment has come under serious threat from a lethal mixture of unprecedented economic growth, inadequate protection, and a lack of planning vision. The stakes are high. For generations to come we will be living with the legacy of the National Development Plan which between now and 2013, will change the face of Ireland. Without active intervention now, this legacy will be one of shoddiness – of sprawling housing estates, overdeveloped coastlines, inadequate public transportation, squalid town and city centres, and lost natural habitats.

### Quality of Life

An Taisce is working for a better quality of life for everyone in Ireland, now and for the future. Our interest is the public interest. Join us in getting better planning for the places where we work, rest and play – and for proper transport.

### A Future for our History

An Taisce makes over 2000 submissions a year on planning matters. Much of this work is hard and unfashionable, but of vital importance. History is vindicating our independent and long-term stance on planning issues .

An Taisce, The National Trust for Ireland, holds in trust 10,500 acres of nature reserve encompassing 47 historic structures on 16 sites across 12 counties. All are maintained, and almost all are funded, through voluntary effort. Generations of Irish people have first encountered heritage conservation and environmental awareness through An Taisce. The very first National Spring Clean was started at An Taisce property. All of our heritage properties are beautiful places, unique for their landscape beauty, historic associations, exceptional workmanship, rare plants and animals. Five our sites form part of designated or tentative World Heritage Sites, six are internationally recognised for nature conservation, while one site - Mongan Bog - is the only complete intact raised midland peatland, one of the rarest and most endangered habitats in Europe.

In addition we hold two of the most important historic buildings in the country, Kanturk Castle in Cork, the largest fortified house ever built by a Gaelic Irish chief, and the Tailors' Hall in Dublin, the place where in many ways the idea of a modern Irish state was born, due to the efforts of Theobald Wolfe Tone and Daniel O'Connell, to name but two of the many historic figures who campaigned for change in it.

### Some of our Achievements

- Over 3,600 schools take part in our Green-Schools programme.
- More than 500,000 people participate in the National Spring Clean annually.
- An Taisce was central in saving historic buildings from destruction. These areas today are key tourist destinations. Temple Bar in Dublin and the Georgian quarters of our cities are perhaps the best known examples.
- We advocated public transport, cycling and walking long before it was fashionable to prioritise low-energy transport. There is now much more political consensus and a realisation that we have to move away from our over-dependence on private cars.
- We initiated opposition to the burning of 'smoky' or bituminous coal in our cities – a major contributor to asthma – which was later banned in cities. Thanks to pressure from An Taisce and others, the ban was extended in 2011.
- An Taisce was central to opposition to nuclear power at Carnsore Point and to the coal and peat burning power stations built over the last 35 years. An Taisce pointed the way towards energy efficiency, and while good progress has been made, much remains to be done. Ireland also has to re-orient its energy supply, making more use of renewable resources in a way that does not harm the environment.
- We opposed the interpretative Centres at Luggala and the Burren, arguing that they should be located in nearby towns instead, where they would generate more employment, giving the cafes, shops and B&Bs in these towns an added boost.
- We argue in favour of sustainable development and against development that requires long-distance car commuting, and is overly-demanding of energy generally. It will become more difficult for families living far from employment to manage as the price of energy rises.
- An Taisce has worked hard to protect special landscapes for future generations. Increasingly, it is acknowledged that these landscapes do have a monetary value, not directly, but in terms of the visitors from home and abroad that pay to stay in these areas because of their natural beauty.

# An Taisce Membership Application Form

Name

---

Address

---

---

Telephone Number

Fax Number

Mobile

E-mail

---

## Membership category – Please tick the appropriate category

Individual €45

Family €55

Retired or unwaged €20

Student €10

Benefactor (Life) €600

Groups €60

Corporate €250

**Payment Method:**  Cheque  Cash  Direct Debit

Please return your completed form to:

**An Taisce – The National Trust for Ireland, Tailor's Hall, Back Lane, Dublin 8**

## Instruction to your Bank to pay Direct Debits

Please complete Parts 1 to 4 to instruct your Bank to make payments directly from your account.

Then return the form to: An Taisce, The National Trust for Ireland, Tailor's Hall, Back Lane, Dublin 8

An Taisce's identification number: **3 0 1 5 6 0**

Your membership Number: \_\_\_\_\_

1. Please write the name and full postal address of your bank and branch:

---

---

---

2. Name of Account Holder:

---

3. Branch Sort Code  Account Number

Banks may refuse to accept instructions to pay Direct Debits from some types of account.

4. Your instructions to the bank and signature

I instruct you to pay Direct Debits from my account at the request of An Taisce.

The amounts are variable and are to be debited on or just after the 1st day of \_\_\_\_\_ annually.

I understand that An Taisce may change the amount and dates only after giving me prior notice.

I will inform the bank in writing if I wish to cancel this instruction.

I understand that if any Direct Debit is paid which breaks the terms of this instruction, the Bank will make a refund.

Please cancel all previous standing order/direct debit instructions in favour of An Taisce.

Signature: \_\_\_\_\_ Date: \_\_\_\_\_