

DIVERSION - WORKS AREA 2

LEGEND

- SITE RESURFACING EXTENT - WORK AREA 2 (For Application of Internal Active Traffic Management Reference Design 18 B021a&b)
- Primary Detour 1 WEST- Advance Warning Traffic Travelling West to Avoid Monkstown
- Primary Detour 1 EAST - Diverting any Traffic from Monkstown Road Side Roads East
- Primary Detour 2 EAST- Diverting Traffic Travelling East to Monkstown/Dun Laoghaire
- Secondary Detour 1a WEST- Diverting Traffic Travelling West to Blackrock/Deansgrange
- Secondary Detour 1b WEST - Diverting Traffic Travelling West to Blackrock/Deansgrange
- Secondary Detour 2 WEST - Diverting Traffic Travelling West to Blackrock/Deansgrange
- SIGN SYMBOL & DIRECTION

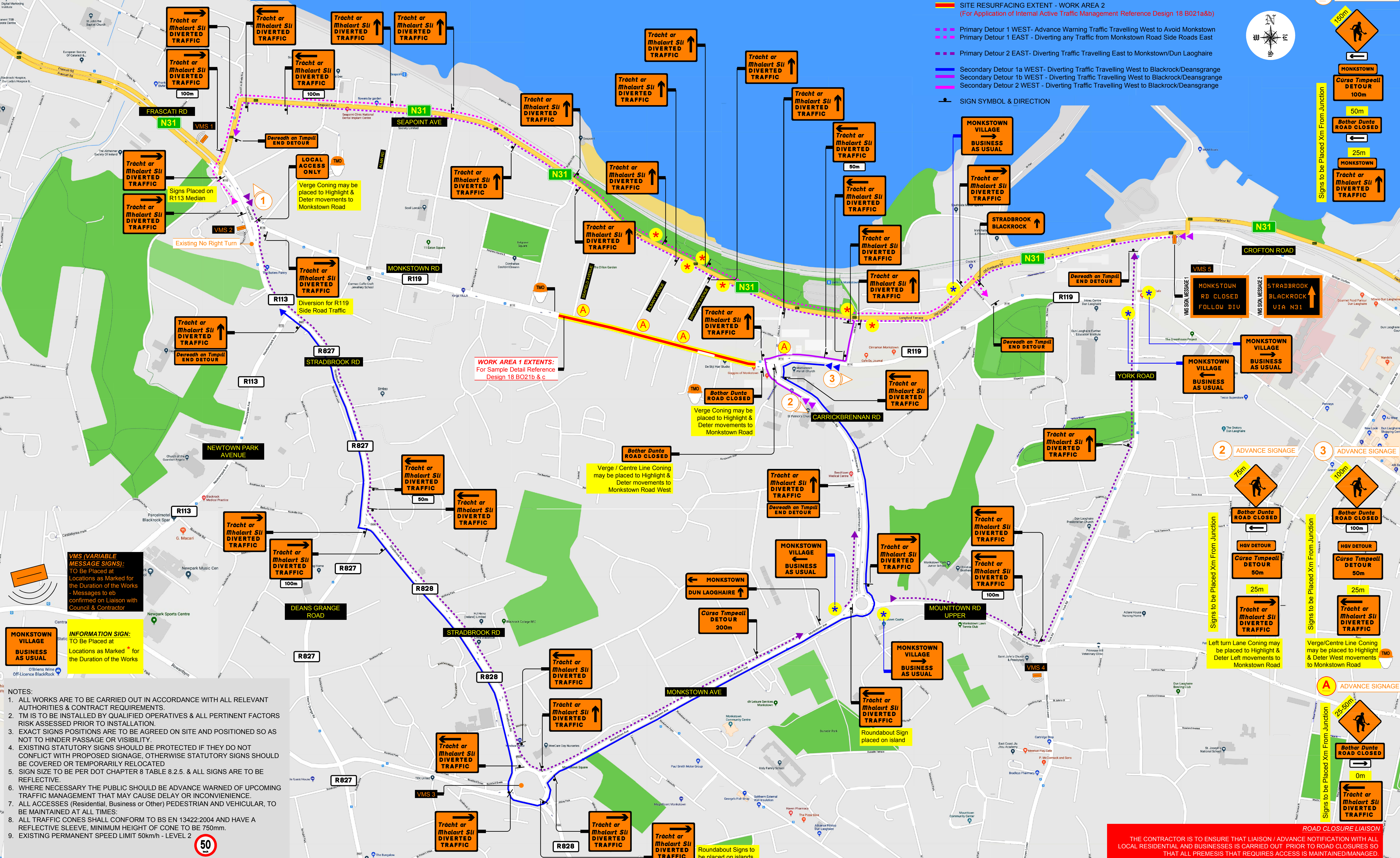

VMS (VARIABLE MESSAGE SIGNS):
TO Be Placed at Locations as Marked for the Duration of the Works. Messages to be confirmed on Liaison with Council & Contractor

INFORMATION SIGN:
TO Be Placed at Locations as Marked * for the Duration of the Works

- NOTES:**
- ALL WORKS ARE TO BE CARRIED OUT IN ACCORDANCE WITH ALL RELEVANT AUTHORITIES & CONTRACT REQUIREMENTS.
 - TM IS TO BE INSTALLED BY QUALIFIED OPERATIVES & ALL PERTINENT FACTORS RISK ASSESSED PRIOR TO INSTALLATION.
 - EXACT SIGNS POSITIONS ARE TO BE AGREED ON SITE AND POSITIONED SO AS NOT TO HINDER PASSAGE OR VISIBILITY.
 - EXISTING STATUTORY SIGNS SHOULD BE PROTECTED IF THEY DO NOT CONFLICT WITH PROPOSED SIGNAGE, OTHERWISE STATUTORY SIGNS SHOULD BE COVERED OR TEMPORARILY RELOCATED
 - SIGN SIZE TO BE PER DOT CHAPTER 8 TABLE 8.2.5, & ALL SIGNS ARE TO BE REFLECTIVE.
 - WHERE NECESSARY THE PUBLIC SHOULD BE ADVANCE WARNED OF UPCOMING TRAFFIC MANAGEMENT THAT MAY CAUSE DELAY OR INCONVENIENCE.
 - ALL ACCESSES (Residential, Business or Other) PEDESTRIAN AND VEHICULAR, TO BE MAINTAINED AT ALL TIMES.
 - ALL TRAFFIC CONES SHALL CONFORM TO BS EN 13422:2004 AND HAVE A REFLECTIVE SLEEVE, MINIMUM HEIGHT OF CONE TO BE 750mm.
 - EXISTING PERMANENT SPEED LIMIT 50km/h - LEVEL 2



ROAD CLOSURE LIAISON
THE CONTRACTOR IS TO ENSURE THAT LIAISON / ADVANCE NOTIFICATION WITH ALL LOCAL RESIDENTIAL AND BUSINESSES IS CARRIED OUT PRIOR TO ROAD CLOSURES SO THAT ALL PREMISES THAT REQUIRES ACCESS IS MAINTAINED/MANAGED.

RS	Description	Date	Rev	By	Date
RS	Design issue for COMMENT or APPROVAL	27/07/18			
Stat	Purpose of Issue				

EQUIPMENT REQ'D	QTY
SIGNS	0
CONES	0
PED TAPE	0m
SITE FENCE	0m
LAMPS (if Req)	0
MASSGUARD	0m
DELTA BLOC	0m



Traffic Management Design Ltd,
Unit 13, Newcourt Shopping Centre,
Church Street, Cavan Town,
Co. Cavan, Ireland.
Tel: +353 (0) 49 4327588
Mob: +353 (0) 86 0442650
Web: www.trafficmanagementdesignltd.com
E-mail: roisino@tmdesign.ie

Designed: RO'R	Client: KILSARAN	Job No: 18.02c
Drawn: RO'R	Project Title: MONKSTOWN ROAD DUN LAOGHAIRE	Drawing No: 18 B022a
Checked: AMC	Drawn Title: TEMPORARY TRAFFIC MANAGEMENT LAYOUT FOR ROAD CLOSURE TO FACILITATE RESURFACING & PROPOSED DIVERSION ROUTE, MONKSTOWN ROAD, DUBLIN (Work Area 2)	Rev: 3
Approved: AV		
CAD File: 18 B022 REV2.dwg		
Scale: AS SHOWN @ A1		
Date: 24/07/2018		